

DAHLIA

lounge

The Dahlia Lounge private dining room offers a warm and elegant setting in the heart of Seattle's quintessential restaurant. The dining room's capacity is flexible and can seat up to 50 guests, or 75 guests for a stand-up reception. The room can be partitioned to suit the needs of smaller groups. Floor to ceiling chenille curtain partitions conceal sound-proof doors to create completely private and intimate settings for any occasion. The award winning cuisine, extensive wine list and outstanding service of Dahlia Lounge make for a truly unparalleled event.

ENTIRE PRIVATE DINING ROOM

SMALLER PARTITIONED ROOMS

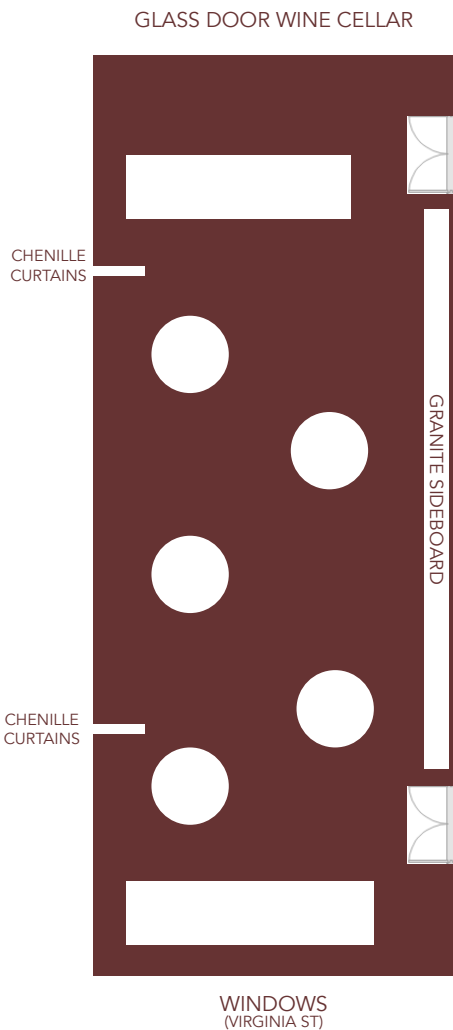

COLUMBIA VALLEY ROOM
660 SQUARE FEET
SEATS UP TO 50

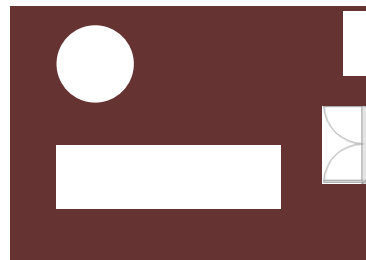

HORSE HEAVEN ROOM
224 SQUARE FEET
SEATS UP TO 20

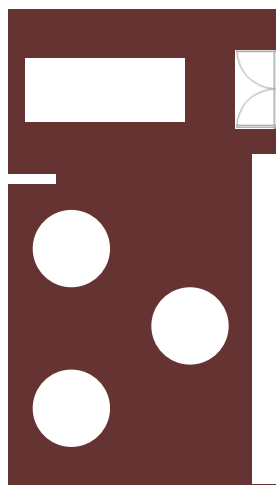

RED MOUNTAIN ROOM
392 SQUARE FEET
SEATS UP TO 30

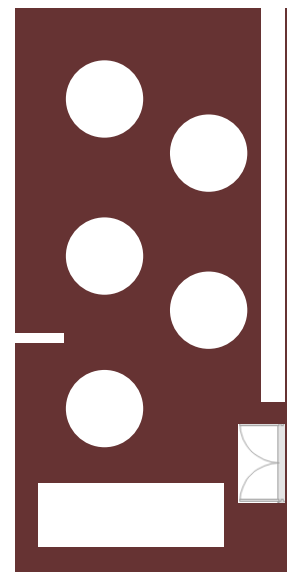

WALLA WALLA VALLEY ROOM
471 SQUARE FEET
SEATS UP TO 40



YAKIMA VALLEY ROOM
140 SQUARE FEET
SEATS UP TO 12